



Instruction Manual for 4K Thin Bezel Series Fixed Frame



MODELS: TF43*, IF169***, TF1610***, TF235*****

Thank you for purchasing a Severtson projection screen. Before use, please read the instructions carefully. After installation, store the instructions for future reference.

Overview

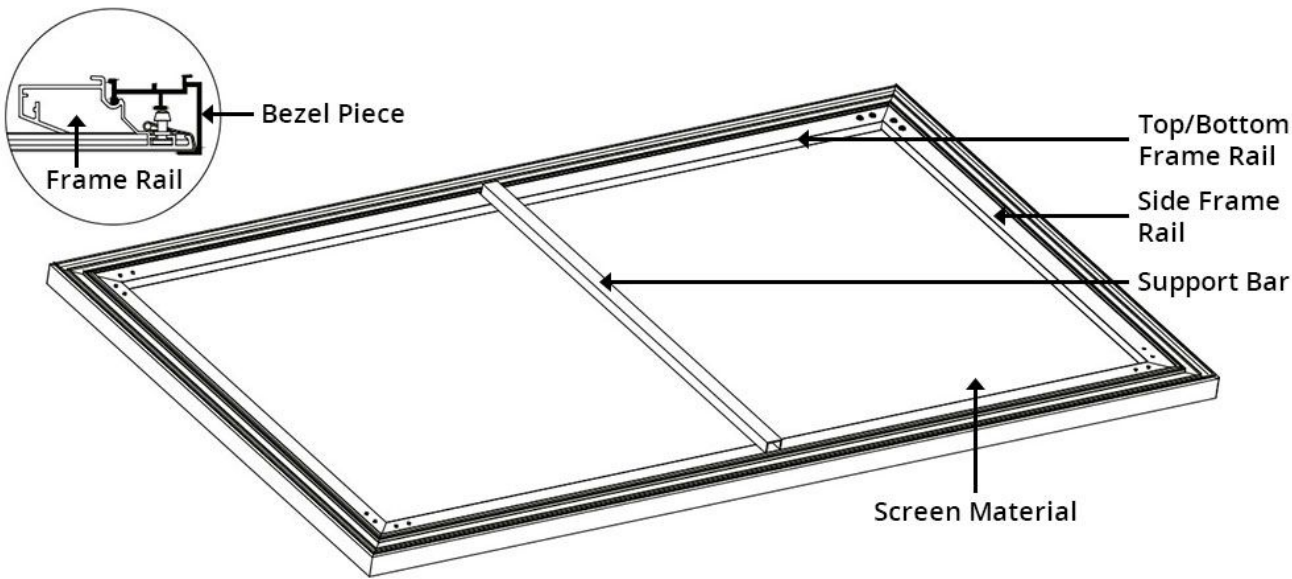

Parts Included

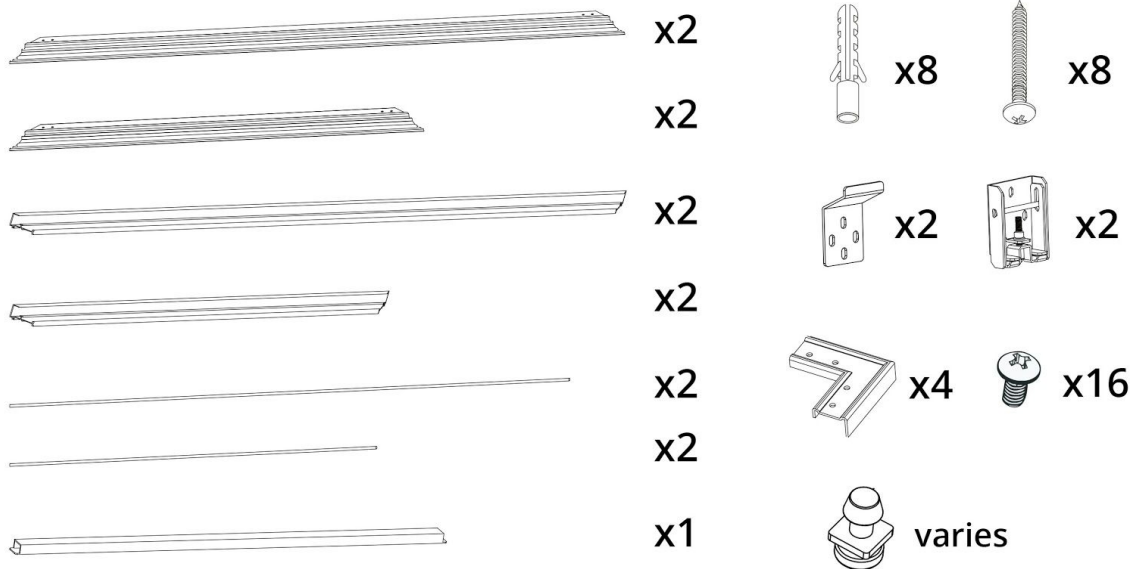

Installation Instructions

Take out all the parts from the packaging and verify that all the parts have been included. Then follow the steps below to install the screen.

1. Locate top, bottom, and side inner frame pieces (the bare aluminum pieces with no velvet) (*Fig. 1.1*) and lay them on a clean, flat surface.

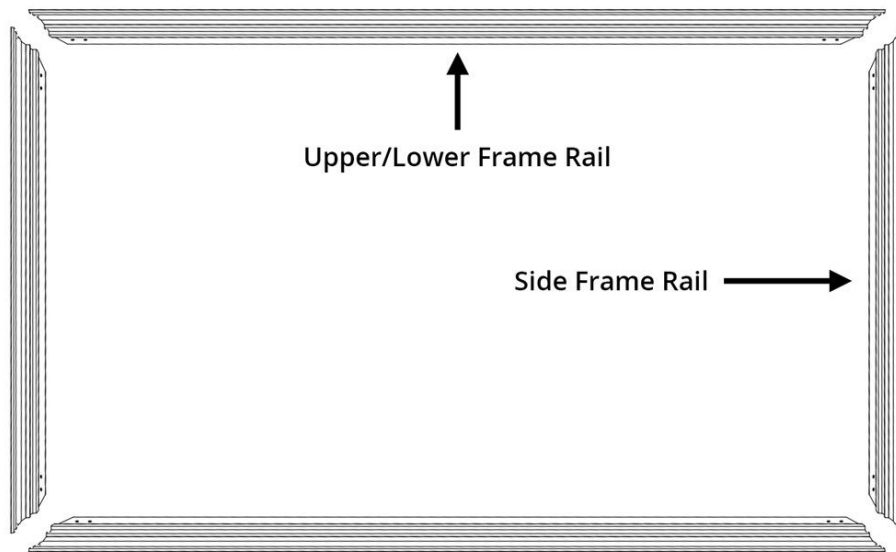

[Figure 1.1]

2. Count out and set aside the plastic fixing lugs for each rail of the frame. The correct quantity is listed on a sticker on each frame rail or can be determined by counting the number of notches on the corresponding side of the screen material. Slide the correct number of fixing lugs into the track on the back of each frame piece (*Fig. 2.1*). Slide a corner bracket into the bracket slot at each angled end of the side frame rails (*Fig. 2.2*). Join the side frame rails to the upper and lower frame rails (*Fig. 2.3*), allowing the exposed bracket to slide into the track at the angled end of each side frame rails.

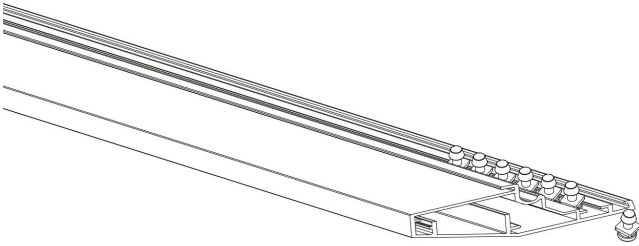

[Figure 2.1]

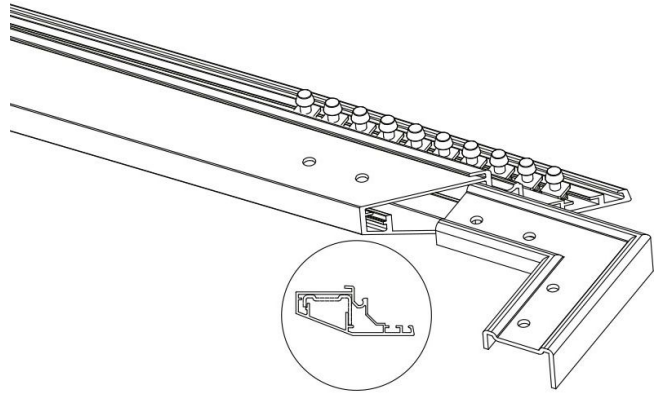

[Figure 2.2]

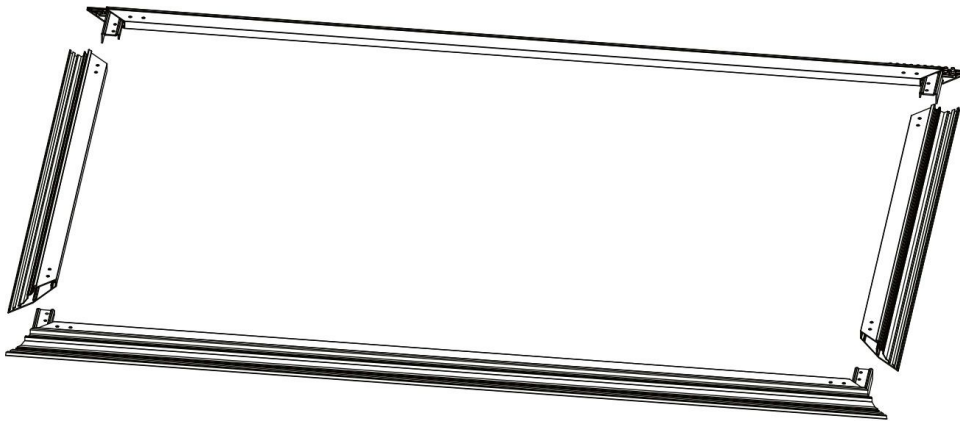

[Figure 2.3]

3. Install the corner bracket screws (*Fig. 3.1 and 3.2*) and leave them slightly loose. Verify that all of the frame corners are tight and square and make an necessary adjustments. Secure the corner brackets in place by fully tightening all of the bracket screws. The frame should now be square at all four corners with no gaps (*Fig. 3.3*).

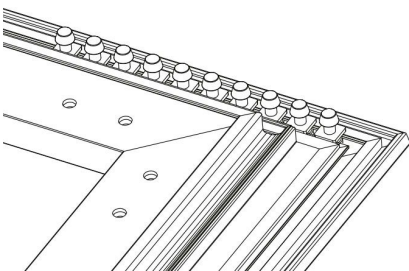

[Figure 3.1]

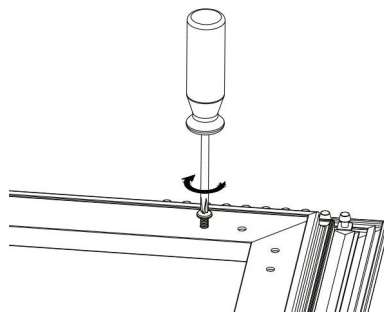

[Figure 3.2]

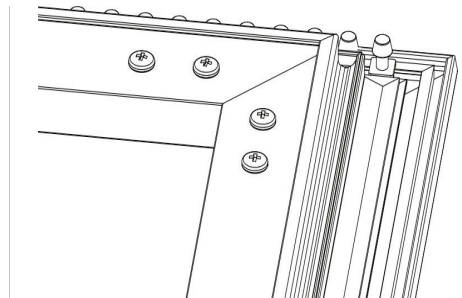

[Figure 3.3]

4. Insert one end of the support bar into the proper track on the frame (*Fig. 4.1*). With one end of the support bar in place, slide the other end of the bar left or right until the angle allows for the end of the bar to slide into the track. Slide the support bar back along the track until it is square with the frame (*Fig. 4.2*).

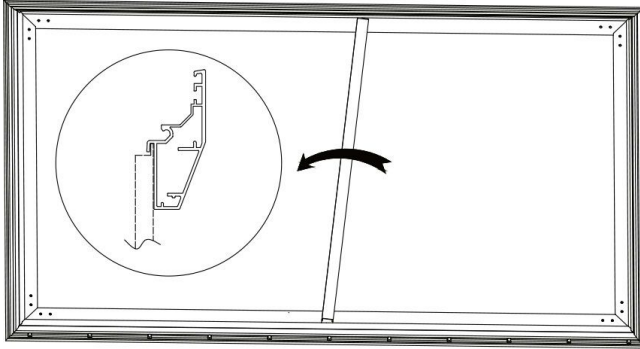

[Figure 4.1]

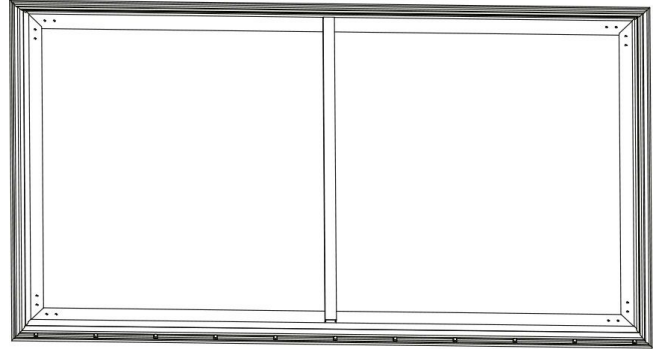

[Figure 4.2]

5. Unroll the screen material and carefully lay it on a clean surface with the projection-side (front side) down and rotated in the correct direction.
6. Lay out the tension rods around the screen material, matching the length of each rod with the corresponding side of the screen material (*Fig. 6.1*). Insert the two side tension rods into the left and right side pockets of the screen material (*Fig. 6.2*). Be careful not to puncture the screen material as you slide the rods through the screen pockets. Insert the two upper/lower rods into the upper and lower pockets of the screen material (*Fig. 6.3*).

Note 6.1: Sometimes it can be difficult to slide the longer rods completely through the pockets. It may be helpful to use one hand to keep tension on the nearest installed short tension rod for leverage while feeding the long tension rod through the longer pocket.

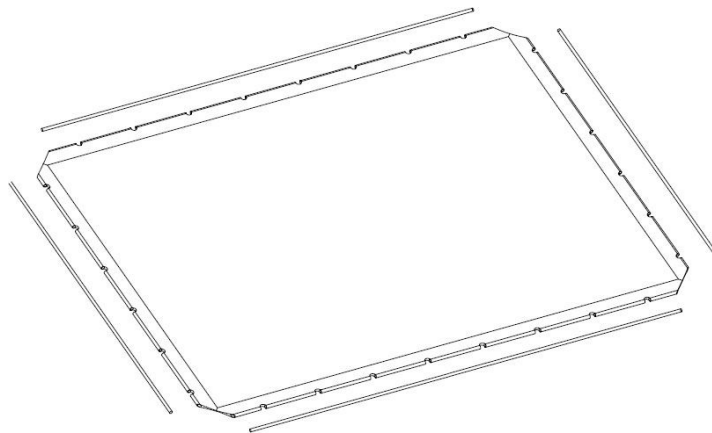

[Figure 6.1]

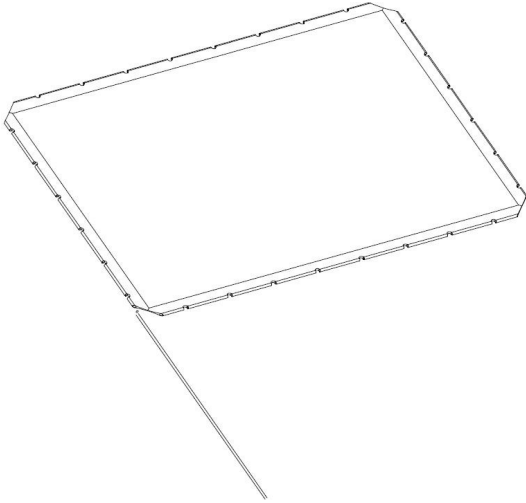

[Figure 6.2]

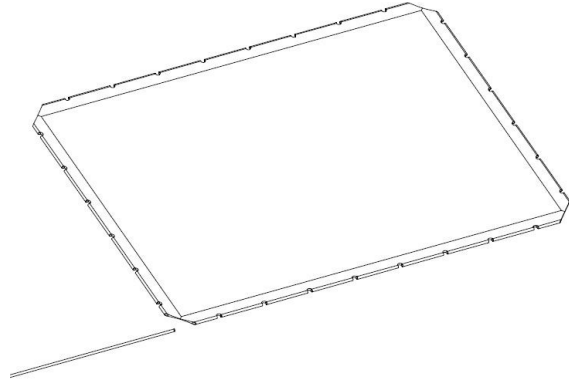

[Figure 6.3]

Note 6.2: For acoustically-transparent screen materials, please see *Appendix A: Black Backing Instructions* in this guide for steps to attach the black backing fabric before attaching the screen to the frame.

7. Lift the assembled frame up and set it carefully on the screen material, centering it between all four edges of the material (*Fig. 7.1*). Starting from the notches near the center of each side of the material, lay the material over the frame and secure the material and rod over each plastic lug at the exposed part of each rod (*Fig. 7.2*). From the attached center notches, work outward to the corners of the frame until the entire screen is tensioned and secured evenly to the frame at all of the plastic lugs (*Fig. 7.3*).

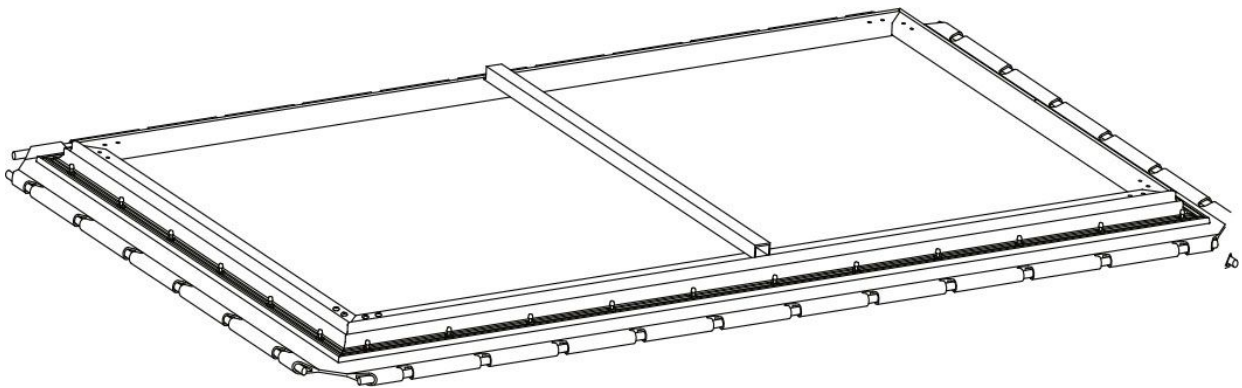

[Figure 7.1]

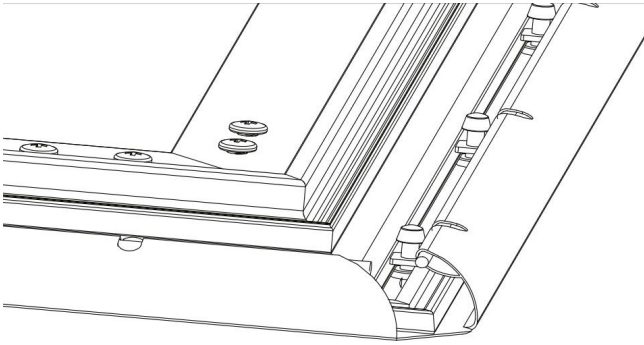

[Figure 7.2]

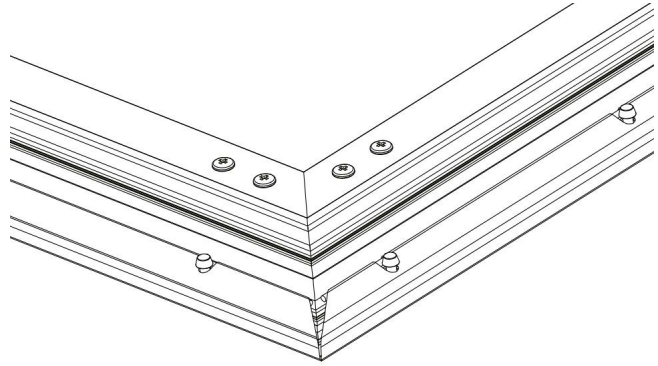

[Figure 7.3]

8. With the screen material properly wrapped and secured all around the frame, lay out each velvet-wrapped frame bezel piece at the corresponding side of the assembled frame. For each velvet-wrapped bezel piece, lift up the assembled frame and snap the front of the bezel in place all along the wrapped material (*Fig. 8.1*). All four sides should now be snapped in place properly (*Fig. 8.2*).

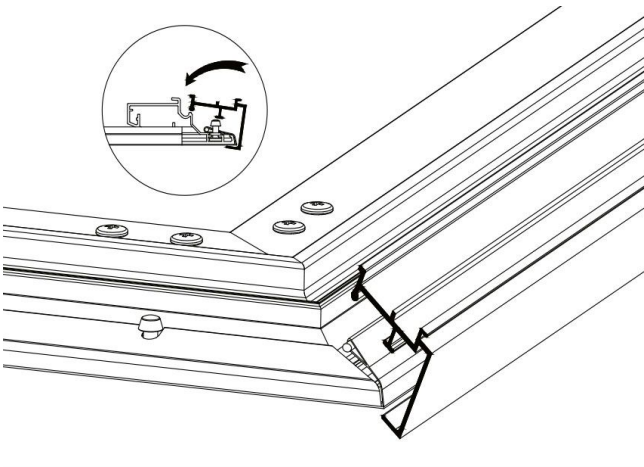

[Figure 8.1]

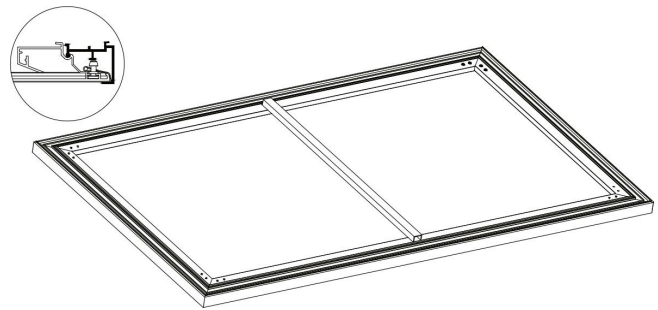

[Figure 8.2]

Note 8.1: If some of the frame bezel pieces get attached incorrectly please see *Appendix B: Bezel Removal Instructions* in this guide for steps to remove the misaligned pieces before attempting to attach them again.

9. Measure the width and height of the completed screen ("A" and "B" respectively - see *Fig. 9.1*). Then attach the upper mounting brackets to the wall (see *Note 9.2* for the appropriate mounting methods). The top of each upper mounting bracket should be approximately 2.5" (64 mm) below the desired location of the top of the frame. The

horizontal distance between the centers of the upper brackets, "C", is determined in *Table 9.1* based on the frame width "A" (*Fig. 9.2*).

Note 9.1: For installations where the screen will be mounted flush to a ceiling, the top of the upper bracket should be placed no less than 2.75" (70 mm) below the ceiling.

Note 9.2: Mounting Surface Types

For a wood framed wall: Locate two studs in the wall that are spaced apart the distance in *Table 9.1* and then secure each bracket to the center of each stud with the included mounting screws. Ensure that the screws fasten firmly into the studs, otherwise the brackets will not be secured.

For a concrete wall: Use an electric drill and a 5/16" (8mm) bit to drill four holes (two for each bracket) and hammer the provided tapping anchors into each hole. Secure the brackets onto the wall by fastening the tapping screws to the tapping anchors.

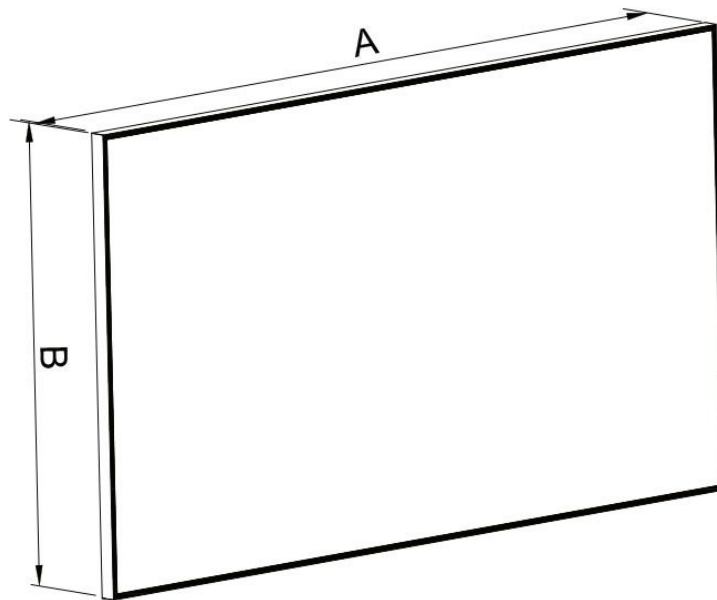

[Figure 9.1]

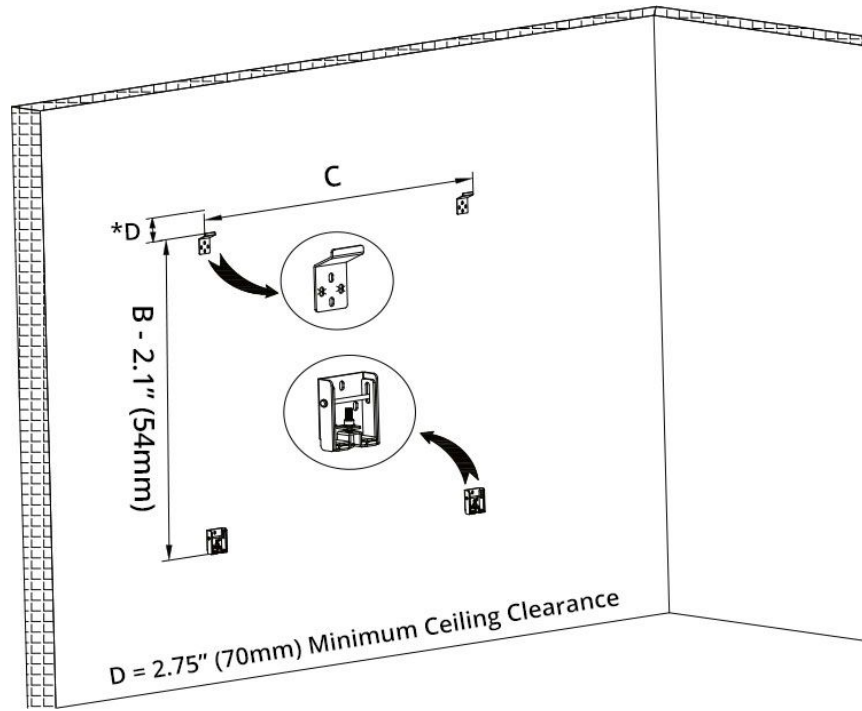

[Figure 9.2]

Table 9.1: Horizontal Bracket Spacing Distance

Frame Width (B)	16" Stud Bracket Spacing (C)	24" Stud Bracket Spacing (C)
Less than 90"	48"	48"
90" to 110"	64"	72"
110" to 135"	80"	72"
135" to 160"	96"	96"
160" to 185"	112"	120"
185" to 210"	128"	120"
210" to 240"	144"	144"
240" to 265"	160"	168"

- Secure the lower brackets to the wall. The lowest part of each bottom bracket (with the locking screw all the way tightened) should be "B" minus 2.1" (54 mm) below the highest part of each upper bracket (Fig. 10.1). The distance between the centers of the lower brackets will also be "C" (previously determined in Table 9.1).

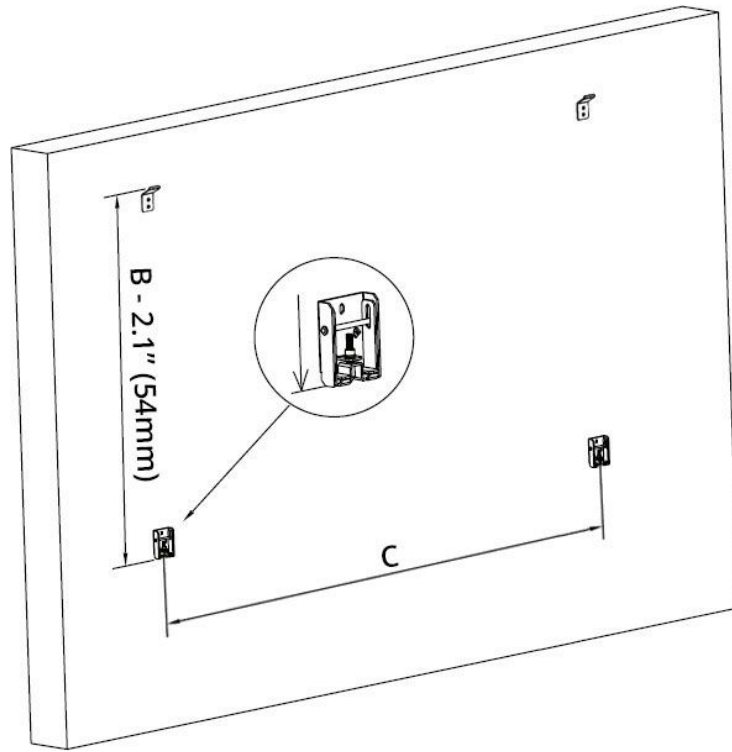

[Figure 10.1]

11. After the lower brackets have been properly secured on the mounting surface, loosen the locking screw on each lower mounting bracket (*Fig. 11.1*).

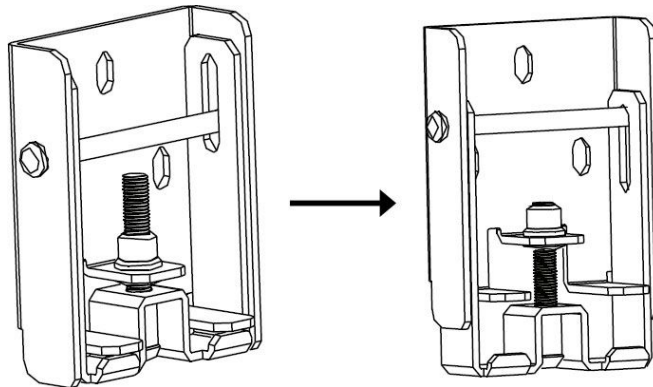

[Figure 11.1]

12. Hang the screen onto the upper brackets, fitting the upper edge of the bracket into the correct track on the frame (*Fig. 12.1*). Then let the screen hang vertically. The back of the lower frame rail should rest against the lower brackets. Adjust the horizontal position of the screen to the desired position, then tighten the locking screws on the bottom of the lower mounting brackets until the tabs of the mounting brackets fit firmly into the track of the frame, locking the frame in place (*Fig. 12.2*).

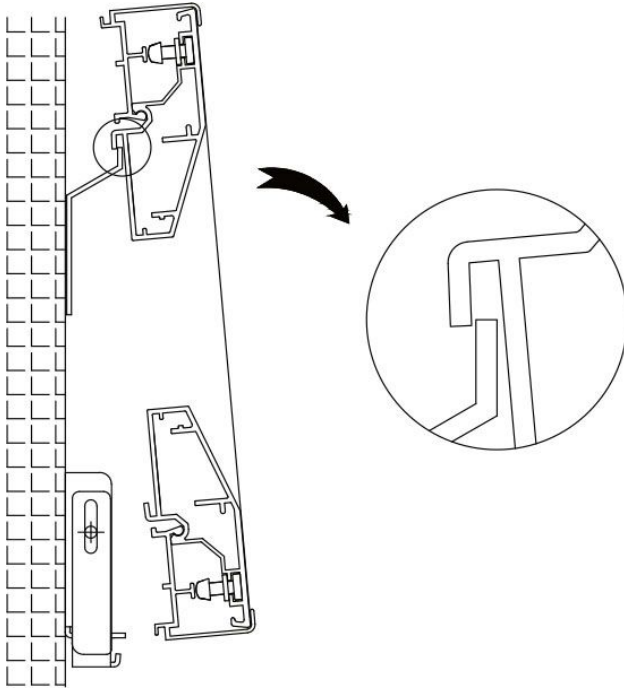

[Figure 12.1]

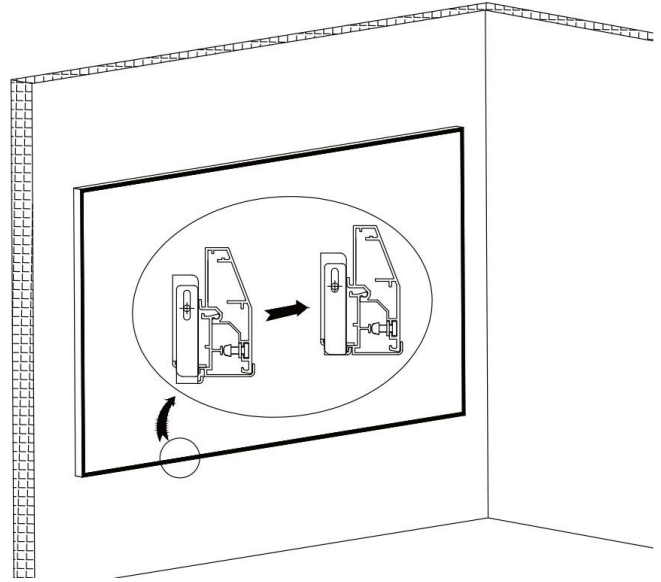

[Figure 12.2]

Appendix A: Black-Backing Instructions

Follow these instructions to properly secure the included black backing to a Severtson Screens Fixed Frame Projection Screen. This guide applies to all 4K Thin Bezel Series Fixed Frame models.

This guide is intended to be followed after the frame has been assembled and the tension rods have been inserted into the screen material, but before the screen material has been attached to the frame.

Before proceeding, ensure that the assembly area is clean and clear of any debris or other objects.

1. Lay out the screen material. Place the screen material front-side (viewing side) down on the floor. Smooth out any wrinkles by hand so that the material is laying completely flat and smooth.
2. Lay out and trim the black backing. Place the black backing material on top of the screen material. Use a sharp pair of scissors to trim the black backing until it is about the same size as the screen material all around (*Fig. A.1*). Use extreme caution not to puncture or damage any part of the screen material when using the scissors to trim.



[Figure A.1]

3. Attach the screen material. Lay the assembled frame on top of the screen material and black backing and then proceed with the rest of the assembly and installation of the screen. As the screen material is attached to the frame, the black backing will be secured as well (*Fig. A.2*). If the black backing becomes bunched up during this step, remove the tension rod from the pin nearest to the bunched material, then pull upward on the black

backing material until the bunched up material smooths out, then proceed with the rest of the assembly and installation.

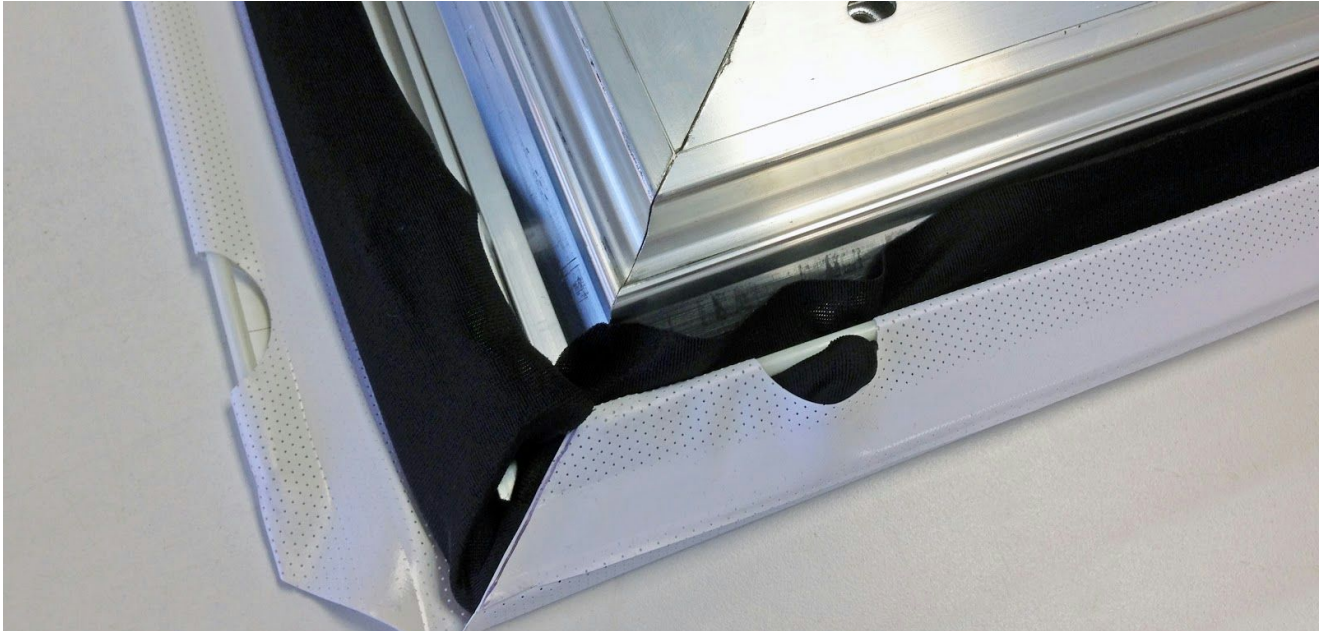

[Figure A.2]

Appendix B: Bezel Removal Instructions

Follow these instructions to properly remove the frame bezel pieces of a Severtson Screens 4K Thin Bezel Series Fixed Frame model projection screen. This may be necessary during the projection screen assembly if a bezel piece was attached incorrectly and needs to be removed before attempting to re-attach it.

Before proceeding, be sure that the screen is laying front-side-down on a clean, flat surface.

1. Locate the bezel piece removal tab. The bezel piece removal tab is the extruding tab on the back of the bezel piece that secures the piece to the screen frame rail (Fig. B.1).

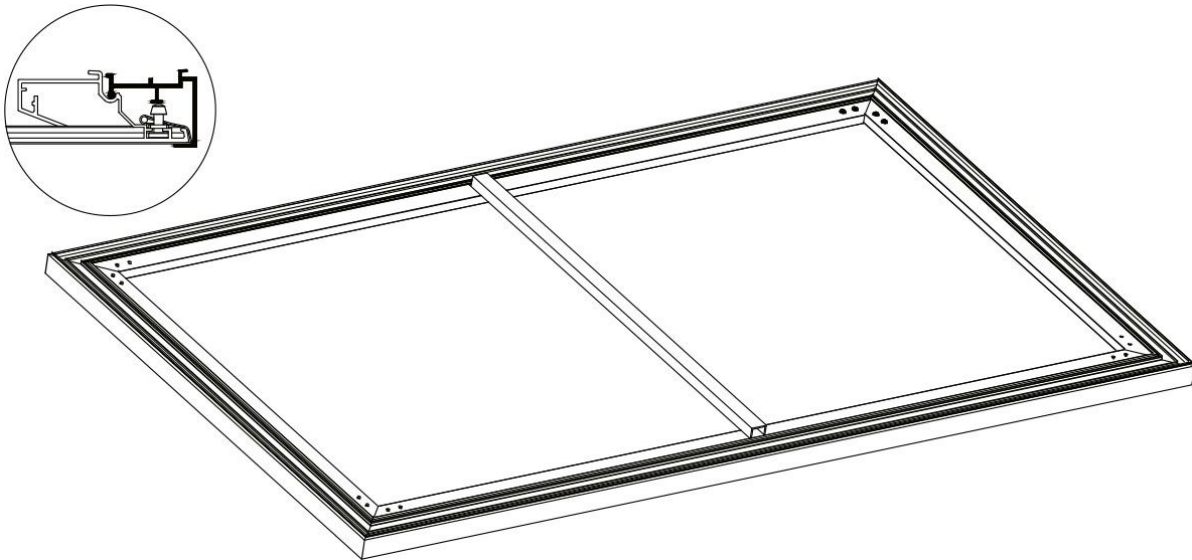

[Figure B.1]

2. Lift up the bezel piece and remove. Insert a flathead screwdriver in between the bezel removal tab and the extrusion on the frame rail and gently pry the bezel piece up (*Fig. B.2*) all along the frame rail until it separates from the frame rail (*Fig. B.3*).

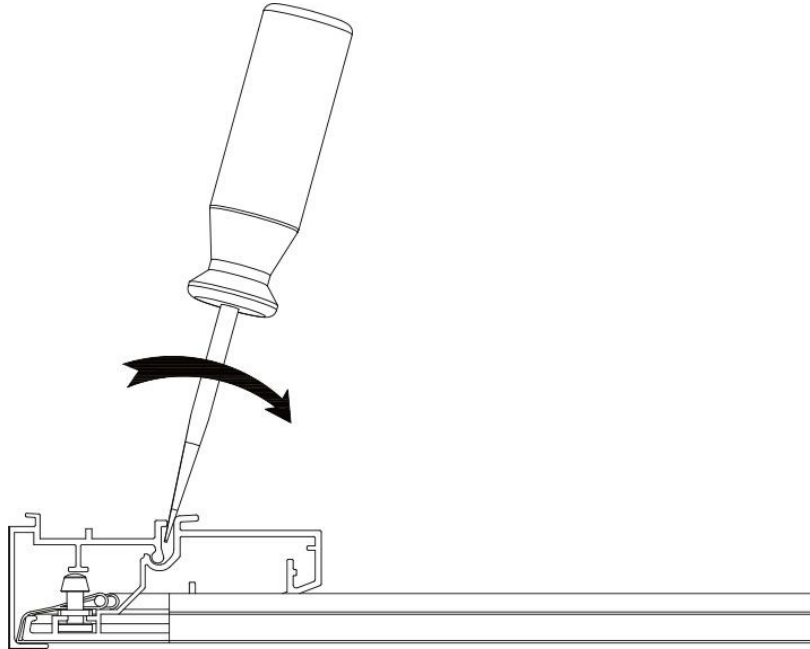

[Figure B.2]

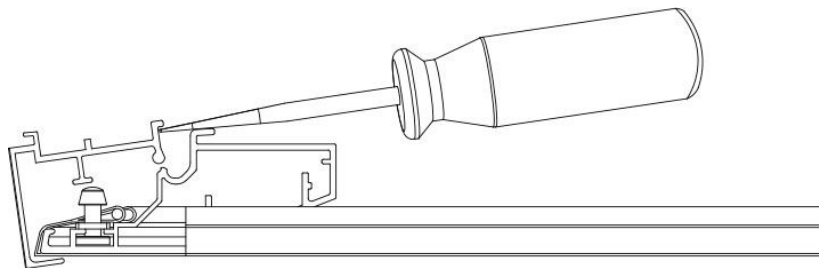

[Figure B.3]

3. Repeat for additional bezel pieces. Repeat this same process to remove additional bezel pieces.

Warnings

1. The frame is made with lightweight aluminum. Please handle with care.
2. Make sure the fasteners used are firmly secured to the wall to avoid any damage.
3. When installing the screen material onto the frame, make sure it is facing forward (viewing side toward the projector).
4. Be careful not to scratch or damage the screen surface while handling it.
5. Do not write or draw on screen surface. Do not poke, fold, or tear screen material.
6. Do not use detergents or harsh chemicals to clean screen material. A soft cloth and mild soap can clean dust and dirt off the screen material. A cotton cloth can be used to gently wipe dust off of the frame.
7. Cover the screen to block out dirt and dust if it is not used for an extended period of time.
8. To prevent unnecessary damage, the assembly and maintenance of the screen should be done by adults.



Ignoring the safety warnings may lead to injuries and/or damaging the product.



Brackets should be installed in a secure place to avoid accidents caused by the screen falling.



Please contact your local dealer for repairs or maintenance. Please contact our company if you have any further questions.

Use caution when installing or removing the screen. Loose parts may cause the screen to fall.