



Spirit Series In-Ceiling Recessed Flush Mount Screens

Instruction Manual for Standard Electric and Tension Deluxe



Thank you for purchasing your Severtson In-Ceiling Projection Screen.

Please read the full manual before installation and use. Keep this manual for future reference.

Warning

1. Install projection screen in a location where screen material and electronic parts cannot get wet.
2. Read instruction manual to prevent accidental damage from incorrect installation methods or operation.
3. Keep screen material and electronic parts far from heat sources such as radiators, portable heaters, fireplaces, or loudspeakers.
4. Only plug into three pronged outlets with a ground.
5. Accessories supplied by authorized Severtson dealers are acceptable to use with this electric projection screen. Using other brand accessories with this screen voids the warranty.
6. Unplug the screen when not in use for long periods of time. Disconnect from power during electrical storms.
7. Any unauthorized repairs or custom changes to the screen material, casing or electronics void the warranty of the screen.
8. Once the screen is connected to a power source the screen is an electrical device and should be treated as one.
9. Before installing this product, please make sure the structure can support up to four times the weight of the product to prevent product from falling and causing damage and injuring someone.
10. There is no need to check parts inside the screen casing. To prevent electrical shock, do not open end caps.

part list

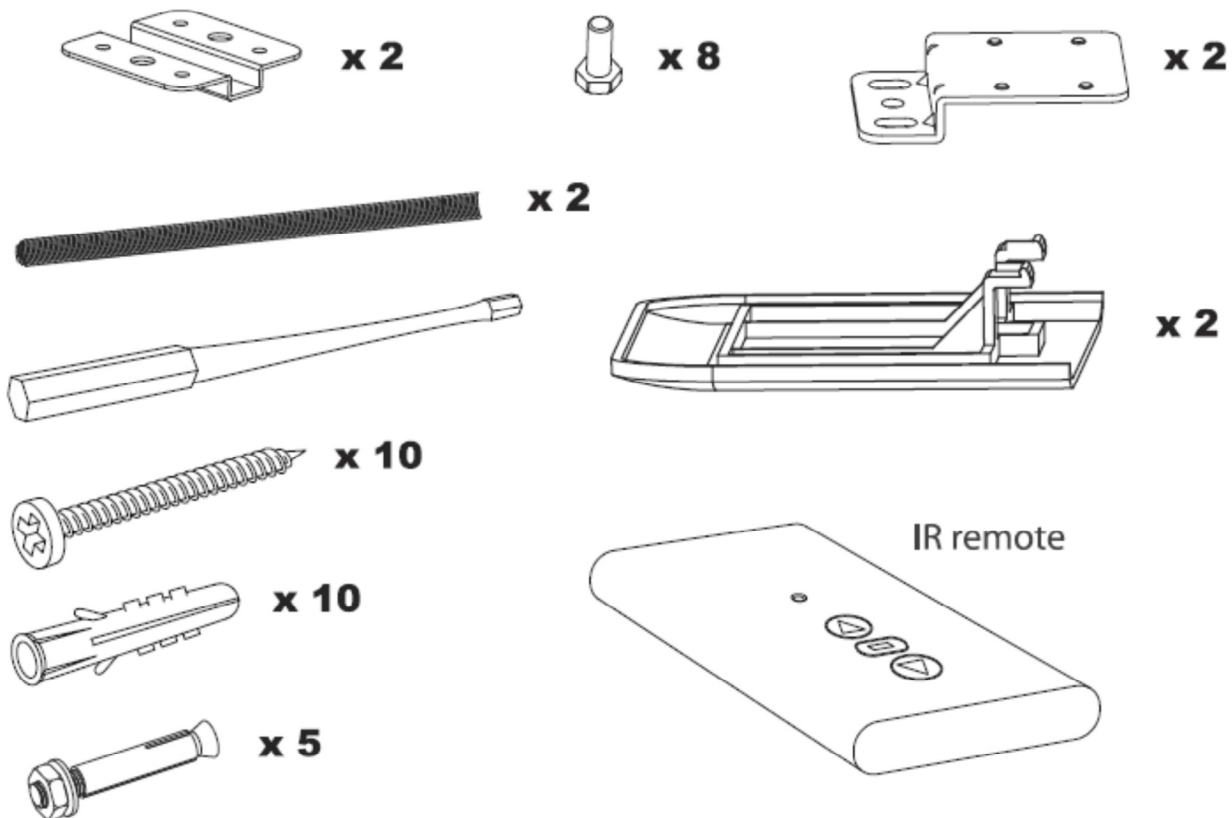

Preparation for the install

When installing the projection screen it is important that you choose the correct fasteners for your ceiling type. Choosing the wrong fasteners can cause damage to the screen and severely injure a person. If you do not know the proper fastener type then it is required to hire a professional.

Find a proper location on your ceiling to install the projection screen. Make sure that no load bearing supports will be cut or compromised during the installation.

Prepare to cut a hole in your ceiling as shown below.

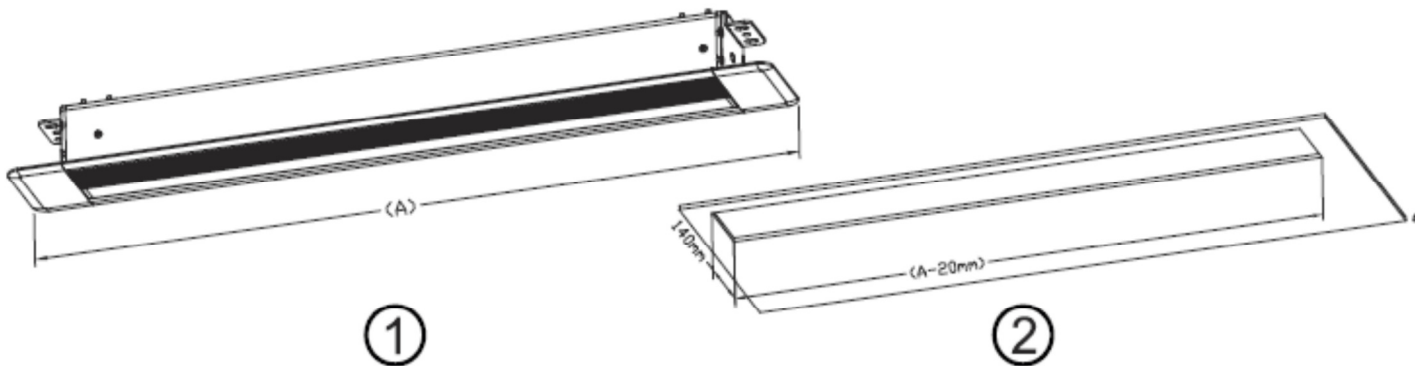

Measure the total width of the case (A) and subtract 20mm(3/4") for your hole length. The hole width will be 140mm(5 1/2"). After you have identified your location and have measured twice you are now prepared to cut once.

Measure and mark the place for your ceiling brackets.

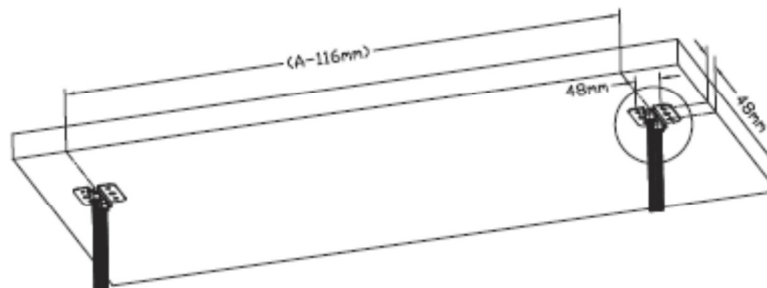

The distance between the center part of each ceiling bracket is (A) and subtract 116mm(4 1/2"). The ceiling mounting bracket holes are placed 48mm(1 7/8") apart.

Installation

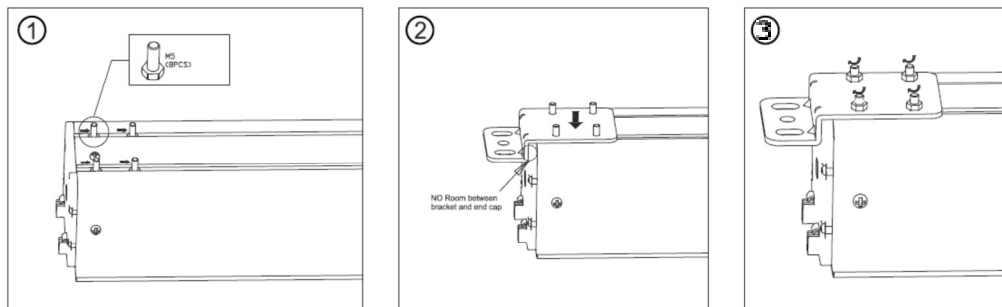

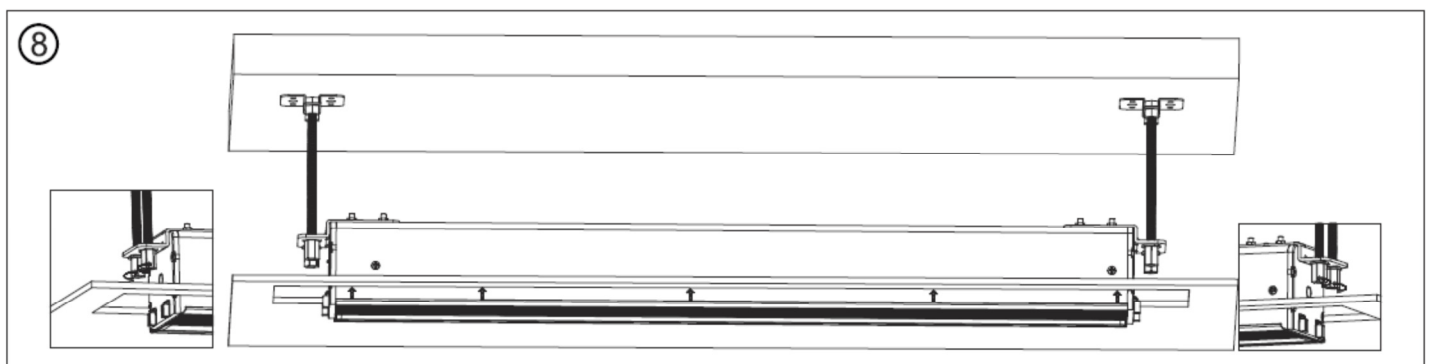
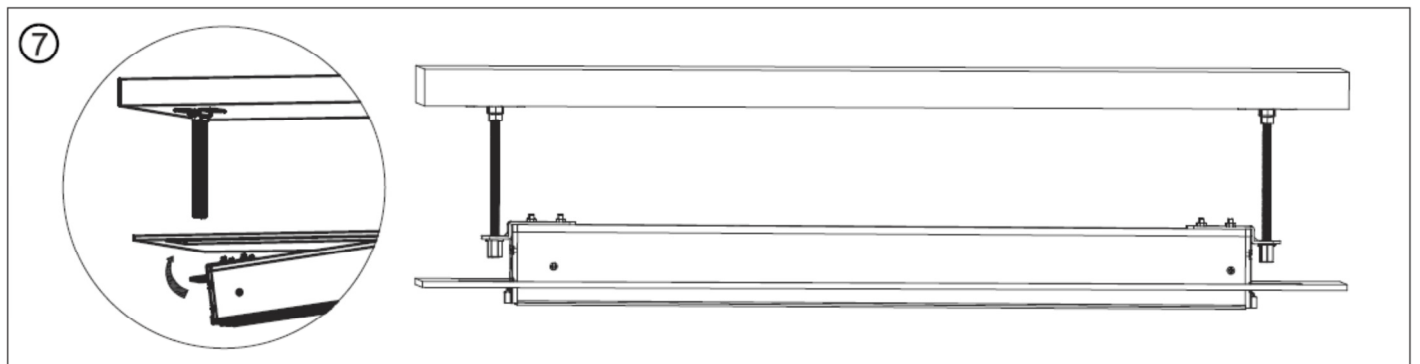
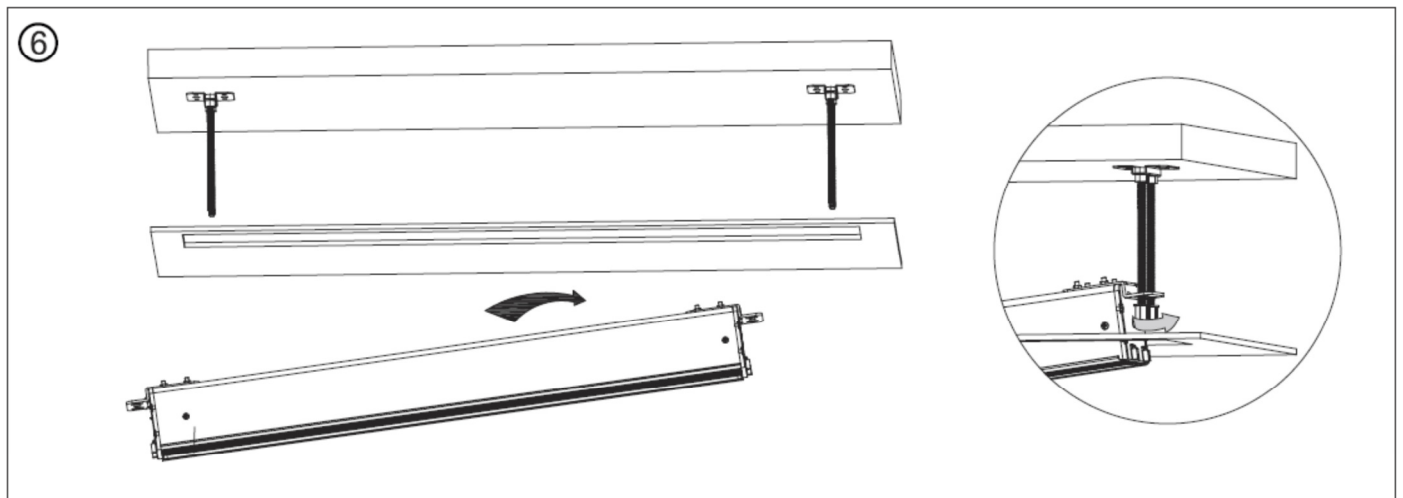
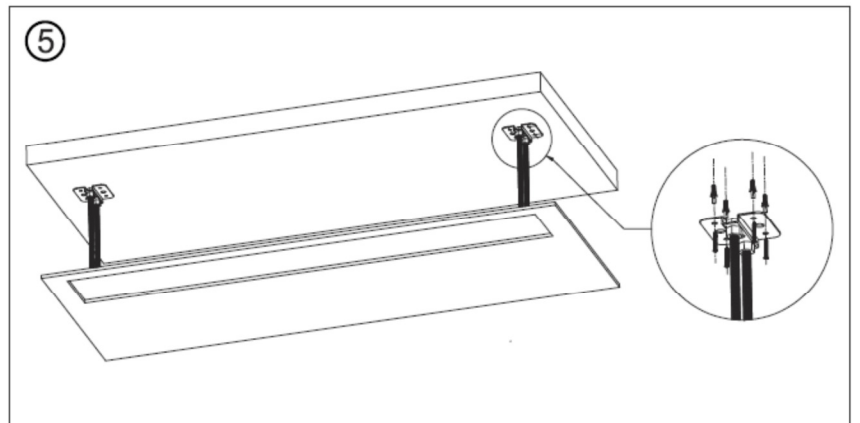
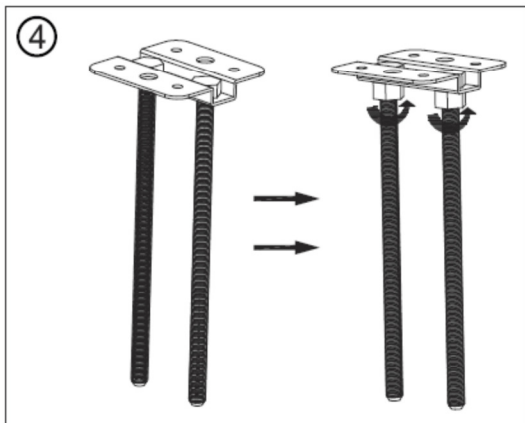

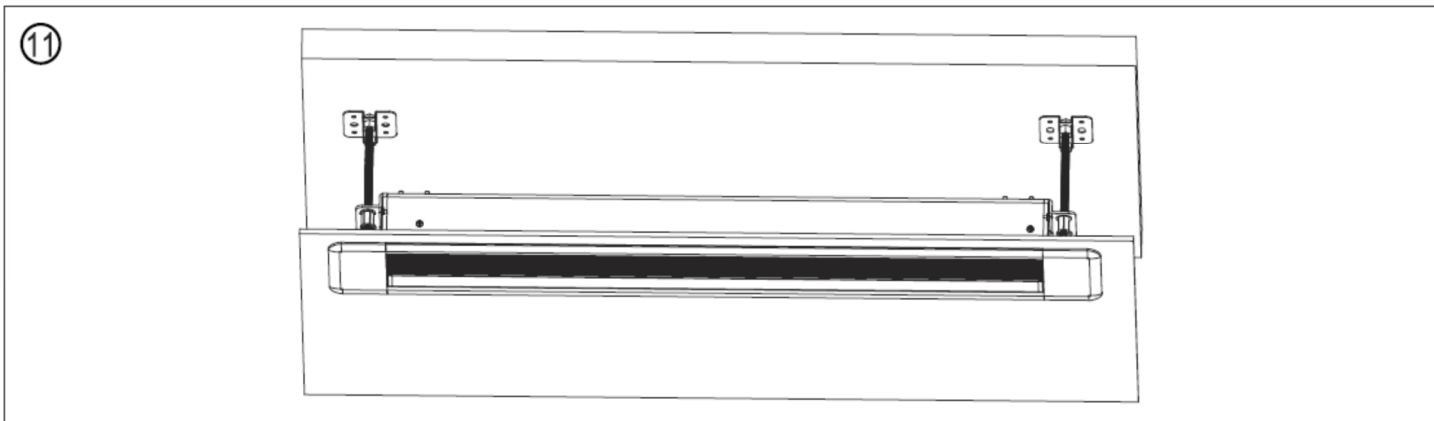
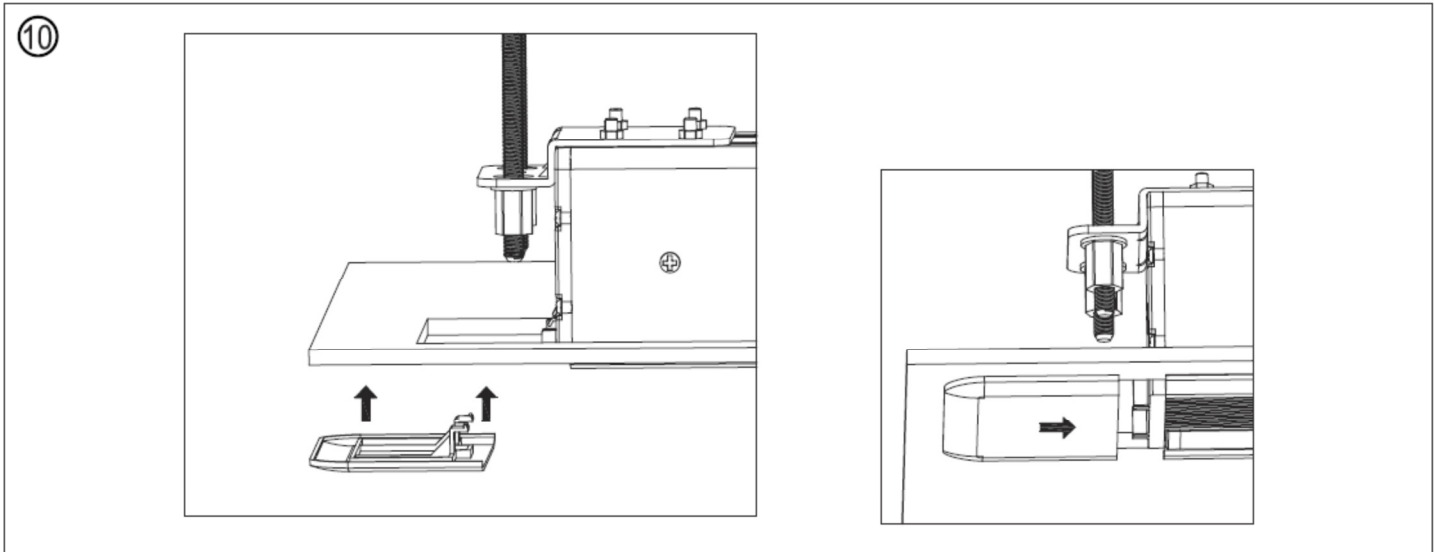
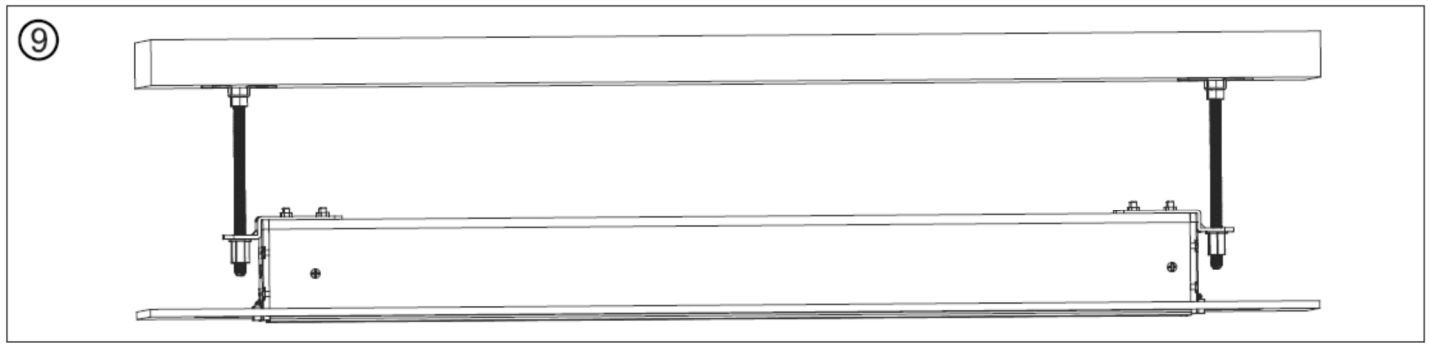

Controlling the projection screen

Make sure all connections are compatible and safe.

Power connection



Side panel

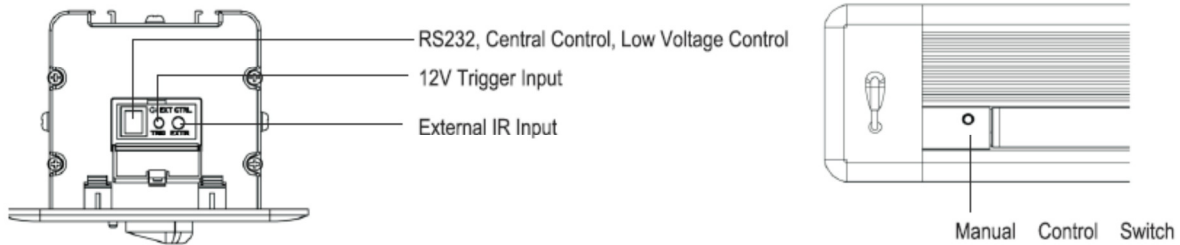

Automatic control (Trigger) Control methods

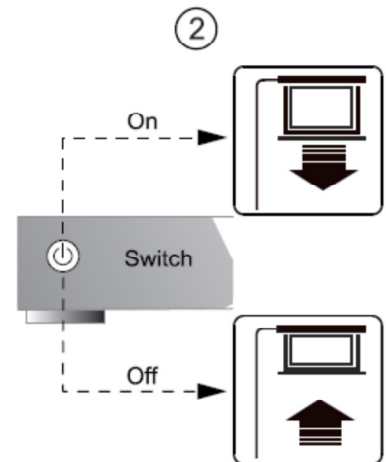
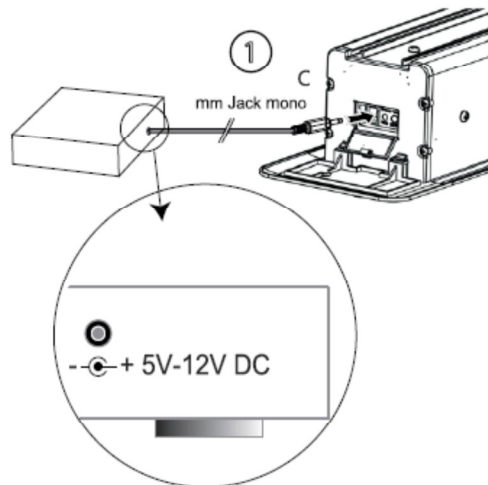
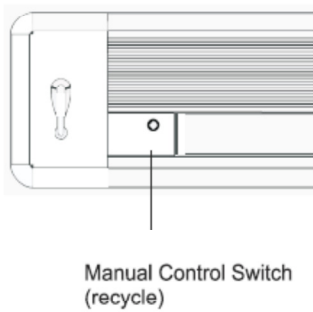

Infrared control

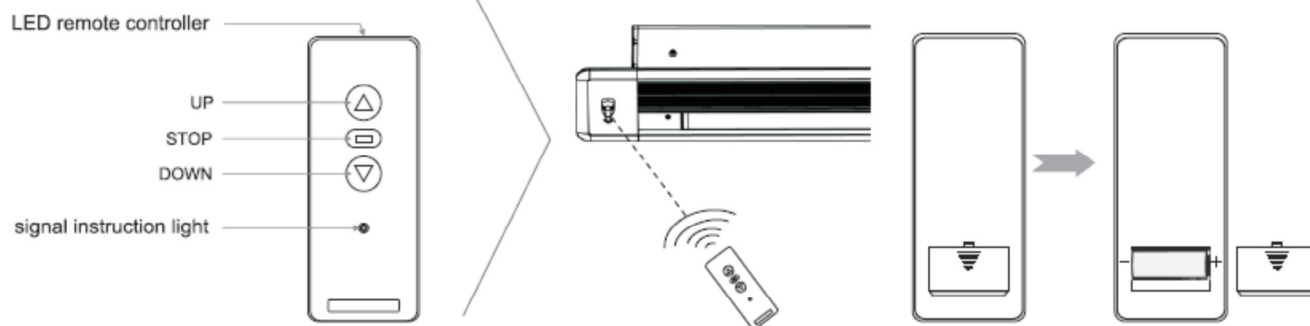

IR controller will work within 30 degrees and 25 feet from the IR eye. The controller will not work if the signal or receiver is covered. Keep the controller away from high temperatures and humidity. Change the battery when the signal is low. You must use the same battery type as the original.

External control (RS232)

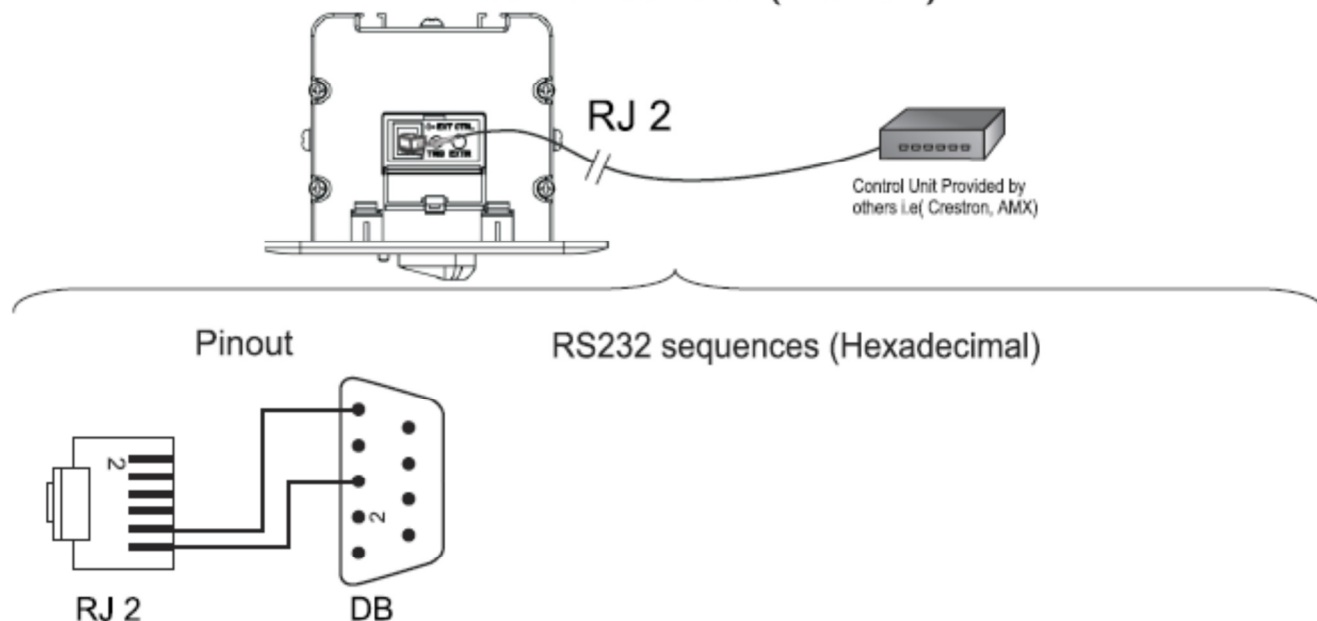

Deluxe Tension Adjustment

String tension adjustment

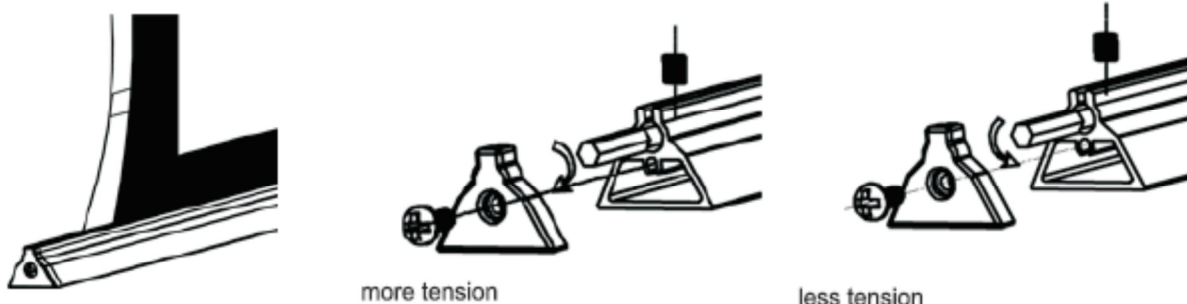

Screen Position Adjustment

We only recommend that experience AV installers adjust the motor limits of the projection screen. The up limit should never be adjusted since it is factory set to flush. Improperly adjusting the limits of the motor will cause damage to the screen and motor and will void all warranty.

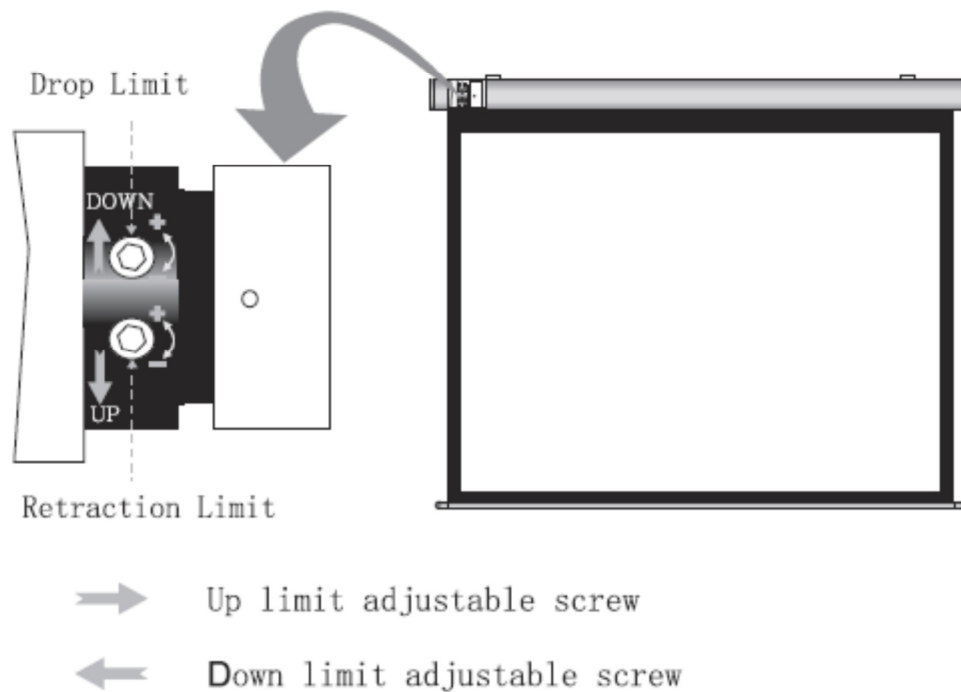

Setting The Up Position.

1. Bring the screen to the down position.
2. Press "up" on the remote control.
3. If the screen does not fully ascend into the case use the accessory tool to adjust the up limit. Turn the Up limit towards the "+" symbol until the screen is at the desired position.
4. If the screen ascends too far then simple turn the same positioning screw towards the "-".

Setting The Down Position.

1. Bring the screen to the up position.
2. Press "down" on the remote control.
3. If the screen does not fully drop to your desired position from the case use the accessory tool to adjust the down limit. Turn the Down limit towards the "+" symbol until the screen is at the desired position.
4. If the screen drops too far then simple turn the same positioning screw towards the "-".

Troubleshooting

The Spirit Series screens are designed for many years of use. Problems are usually simple to resolve and caused by small issues or improper end use. If problems persist, please contact us.

What to do if:

Screen does not retract	<ul style="list-style-type: none">• Power cable is not connected or outlet does not have power.• Check the connection of the power cable
Screen goes too low or does not go down enough	<ul style="list-style-type: none">• Adjust the down limit as described
Screen goes too far into case or does not ascend to the correct position.	<ul style="list-style-type: none">• Adjust the up limit as described
IR control does not work	<ul style="list-style-type: none">• Check the batteries in the IR remote• Check to make sure you are in the IR range• Close windows or shut off lights that may be diffusing the IR signal

Please contact us with any unresolved questions.

Care of projection screen

1. Do not clean the screen case with water. Only dust the screen casing to avoid electrical shock.
2. To clean screen material use warm light soapy water. Never use chemicals or abrasives when cleaning the material as this will damage the screen surface and ruin your viewing experience.

Contact Information:

Severtson Corporation
216 S. Alma School Rd. Suite 3
Mesa, AZ 85210 USA
480-610-5155
info@severtsonscreens.com